

# ACCESS DOOR EXIT DEVICE ORDER FORM

GSTBFH-1 ADA

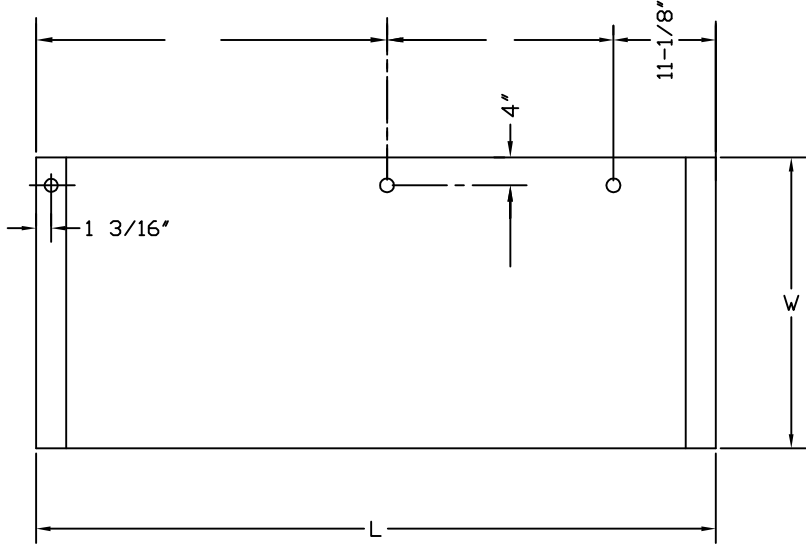

REQ'D	W	L	SWING

DOOR SWING

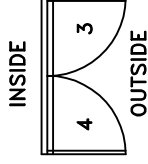

PLEASE SPECIFY:

- FINISH \_\_\_\_\_
- GLASS THICKNESS \_\_\_\_\_
- JAMB CONDITION \_\_\_\_\_
- INTERIOR HANDLE \_\_\_\_\_
- EXTERIOR HANDLE \_\_\_\_\_
- HOLE DIAMETER (CIRCLE):

- 5/8" DIA. FOR 1/2" GLASS
- 7/8" DIA. FOR 3/4" GLASS

ELECTRICAL REQUIREMENTS: \_\_\_\_\_

- POWER: 12-24 VOLT AC OR DC
- CURRENT DRAW: 5mA AT REST, 25mA ACTIVE
- CONTACTS: DPST (NC & NO), 1 AMP AT 24 VOLTS
- WIRE: 6 CONDUCTOR, 22 GAUGE (16 FEET PROVIDED)

- CLOSER \_\_\_\_\_
- DOOR CORD: BLK./STAINLESS (CIRCLE)
- DOOR MFR. \_\_\_\_\_
- RAIL HEIGHT \_\_\_\_\_

JOB INFORMATION: \_\_\_\_\_

JOB NAME: \_\_\_\_\_ GLAZING CONTRACTOR: \_\_\_\_\_  
 LOCATION: \_\_\_\_\_