

# ACCESS ARCHITECTURAL HARDWARE

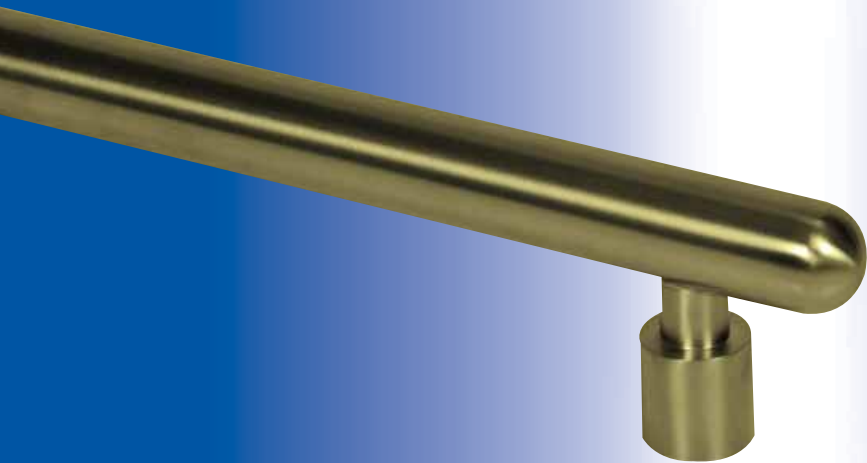

ACCESS DOOR  
[www.accessdoor.us](http://www.accessdoor.us)

ARCHITECTURAL PUSH-PULL HARDWARE

# ACCESS ARCHITECTURAL HARDWARE



Access Architectural Hardware is a US Company located in the heartland of America. We have over 75 years of experience manufacturing and supplying premium quality architectural push pull hardware and other hardware designed to be used in the commercial door, glass and aluminum industry.

We possess an extensive manufacturing facility with bending, welding, metal finishing, and CNC machining capabilities. We pride ourselves on our ability to interpret, design and fabricate a wide variety of custom architectural handles and related products. We have developed a reputation within our industry for providing high quality products at competitive prices and lead times that meet our customer's requirements.

Access Architectural Hardware is the exclusive manufacturer of "Smart Touch" and "Smart Grip" exit devices for all glass and framed door applications.



## Access Architectural Hardware

(319) 208-7822 • Fax (319) 208-7708 • [www.aahardware.us](http://www.aahardware.us)

# AA1000 SERIES

## (WIRE PULLS, AND PUSH BARS)

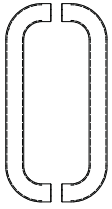

<b>AA1100 Series 1" Diameter</b>			
<b>Part #</b>	<b>Material</b>	<b>Projection</b>	<b>C. to C.</b>
AA1110	1.00" Dia.	2-1/2"	10"
AA1112	1.00" Dia.	2-1/2"	12"
AA1100	1.00" Dia.	Specify	Specify

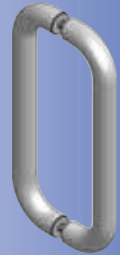

<b>AA1200 Series 1-1/4" Diameter</b>			
<b>Part #</b>	<b>Material</b>	<b>Projection</b>	<b>C. to C.</b>
AA1210	1.25" Dia.	3.00"	10"
AA1212	1.25" Dia.	3.00"	12"
AA1200	1.25" Dia.	Specify	Specify



<b>AA1300 Series 1" Offset Pulls</b>			
<b>Part #</b>	<b>Material</b>	<b>Projection</b>	<b>C. to C.</b>
AA1310	1.00" Dia.	2-3/4"	10"
AA1312	1.00" Dia.	2-3/4"	12"
AA1300	1.00" Dia.	Specify	Specify



<b>AA1400 Series 1-1/4" Offset Pulls</b>			
<b>Part #</b>	<b>Material</b>	<b>Projection</b>	<b>C. to C.</b>
AA1410	1.25" Dia.	3.00"	10"
AA1412	1.25" Dia.	3.00"	12"
AA1400	1.25" Dia.	Specify	Specify

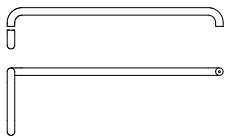

<b>AA1500 Push Pull Combination Sets</b>			
<b>Part #</b>	<b>Material</b>	<b>Pull C. to C.</b>	<b>Push C. to C.</b>
AA1500	1.00" Dia.	Specify	Specify
AA1550	1.25" Dia.	Specify	Specify

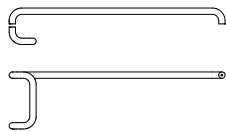
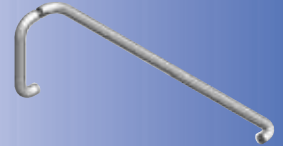

<b>AA1600 Push Pull Combination Sets</b>			
<b>Part #</b>	<b>Material</b>	<b>Pull C. to C.</b>	<b>Push C. to C.</b>
AA1600	1.00" Dia.	Specify	Specify
AA1650	1.25" Dia.	Specify	Specify

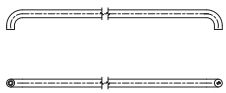
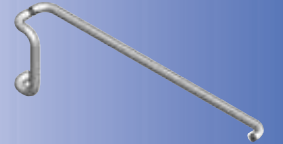

<b>AA1700 Push Bars Solid and Tubular</b>		
<b>Part #</b>	<b>Material</b>	<b>Push C. to C.</b>
AA1710	1.00" Dia.	Specify
AA1720	1.25" Dia.	Specify
AA1730	Specify	Specify



The contemporary 1" diameter series is the current industry standard and is available both in tubular and solid material in all architectural finishes. The 1-1/4" diameter push and pull handles are manufactured from 16 gauge tubular material and while being more substantial in size they still provide the same contemporary appearance as the 1" diameter series.

Both the 1" diameter and 1-1/4" diameter series are available in a split finish.

# AA2000 SERIES

## (LADDER PULLS)



AA2100 Series			
Part #	Material	Base	Length
AA2110	1.00" Dia.	1.00" Dia.	Specify
AA2120	1.25" Dia.	1.25" Dia.	Specify
AA2130	1.50" Dia.	1.25" Dia.	Specify

AA2200 Series			
Part #	Material	Base	Length
AA2210	1.00" Dia.	1.00" Dia.	Specify
AA2220	1.25" Dia.	1.25" Dia.	Specify
AA2230	1.50" Dia.	1.25" Dia.	Specify

AA2300 Series			
Part #	Material	Base	Length
AA2310	1.00" Dia.	1.00" Dia.	Specify
AA2320	1.25" Dia.	1.25" Dia.	Specify
AA2330	1.50" Dia.	1.25" Dia.	Specify

AA2400 Series			
Part #	Material	Base	Length
AA2410	1.00" Dia.	1.00" Dia.	Specify
AA2420	1.25" Dia.	1.25" Dia.	Specify
AA2430	1.50" Dia.	1.25" Dia.	Specify

AA2500 Series			
Part #	Material	Base	Length
AA2510	1.00" Dia.	1.00" Dia.	Specify
AA2520	1.25" Dia.	1.25" Dia.	Specify
AA2530	1.50" Dia.	1.25" Dia.	Specify

AA2600 Series			
Part #	Material	Base	Length
AA2610	1.00" Dia.	1.00" Dia.	Specify
AA2620	1.25" Dia.	1.25" Dia.	Specify
AA2630	1.50" Dia.	1.50" Dia.	Specify

AA2700 Series			
Part #	Material	Base	Length
AA2710	1.00" Dia.	1.00" Dia.	Specify
AA2720	1.25" Dia.	1.25" Dia.	Specify
AA2730	1.50" Dia.	1.50" Dia.	Specify

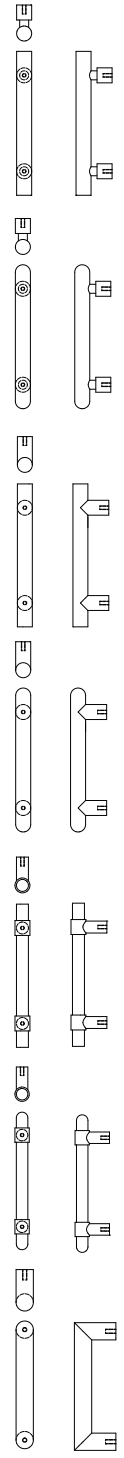

The AA2000 series ladder pulls are available in a variety of styles, sizes and finishes. These contemporary pulls can be manufactured in a split finish which adds an elegant contrast to almost any style of pull. Access Architectural Hardware highly recommends that a center mounting post be added to bars 60" on center or greater. Mounting options include single sided or back to back mounting on glass, wood or storefront doors.



**Access Architectural Hardware**  
 (319) 208-7822 • Fax (319) 208-7708 • [www.aahardware.us](http://www.aahardware.us)

# AA3000 SERIES

## (OVAL PUSH/PULLS)

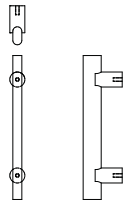

**Part #**  
AA3110  
AA3120

**AA3100 Series**  
**Material**  
3/4" x 1 1/2" Oval  
1" x 1 1/2" Oval

**Length**  
Specify  
Specify

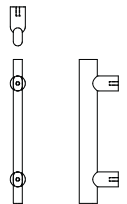

**Part #**  
AA3210  
AA3220

**AA3200 Series**  
**Material**  
3/4" x 1 1/2" Oval  
1" x 1 1/2" Oval

**Length**  
Specify  
Specify

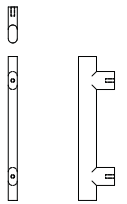

**Part #**  
AA3310  
AA3320

**AA3300 Series**  
**Material**  
3/4" x 1 1/2" Oval  
1" x 1 1/2" Oval

**Length**  
Specify  
Specify

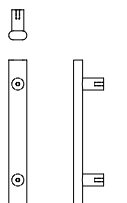

**Part #**  
AA3410  
AA3420

**AA3400 Series**  
**Material**  
3/4" x 1 1/2" Oval  
1" x 1 1/2" Oval

**Length**  
Specify  
Specify

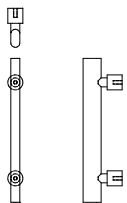

**Part #**  
AA3510  
AA3520

**AA3500 Series**  
**Material**  
3/4" x 1 1/2" Oval  
1" x 1 1/2" Oval

**Length**  
Specify  
Specify

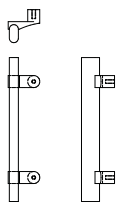

**Part #**  
AA3610  
AA3620

**AA3600 Series**  
**Material**  
3/4" x 1 1/2" Oval  
1" x 1 1/2" Oval

**Length**  
Specify  
Specify

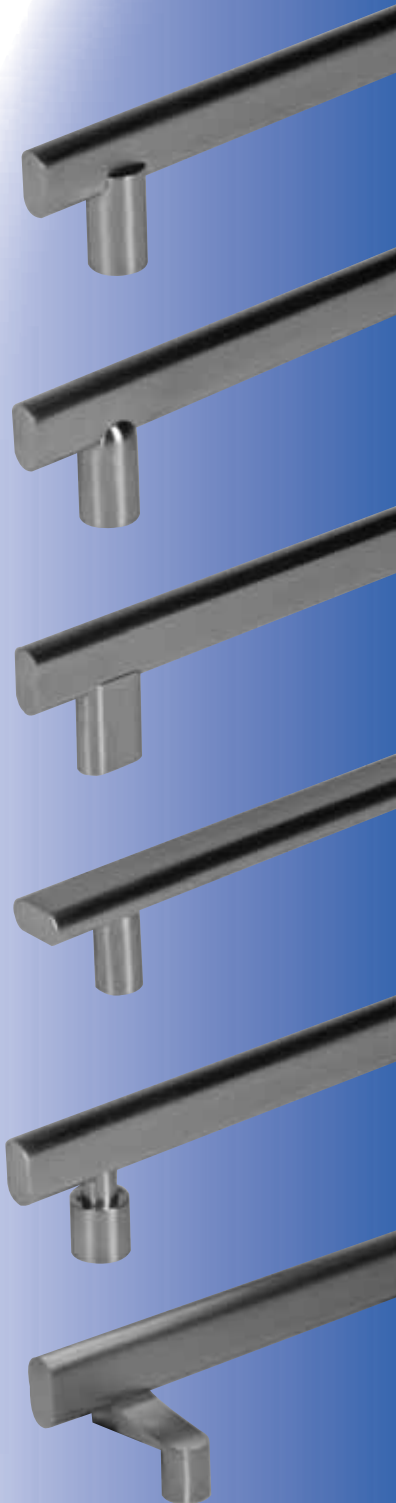

Architectural appeal best describes the AA3000 series of door pulls. The handles are manufactured from oval material which provides a comfortable grip and will enhance the appearance of any type of door. These handles can be mounted vertically or horizontally and are available with multiple mounting post options. The handles are available in a variety of finishes as well as the popular split finish. Access Architectural Hardware highly recommends that a center mounting post be added to bars 60" on center or greater.

**Access Architectural Hardware**  
(319) 208-7822 • Fax (319) 208-7708 • [www.aahardware.us](http://www.aahardware.us)





# AA4000 SERIES

## (OFFSET LADDER PULLS)

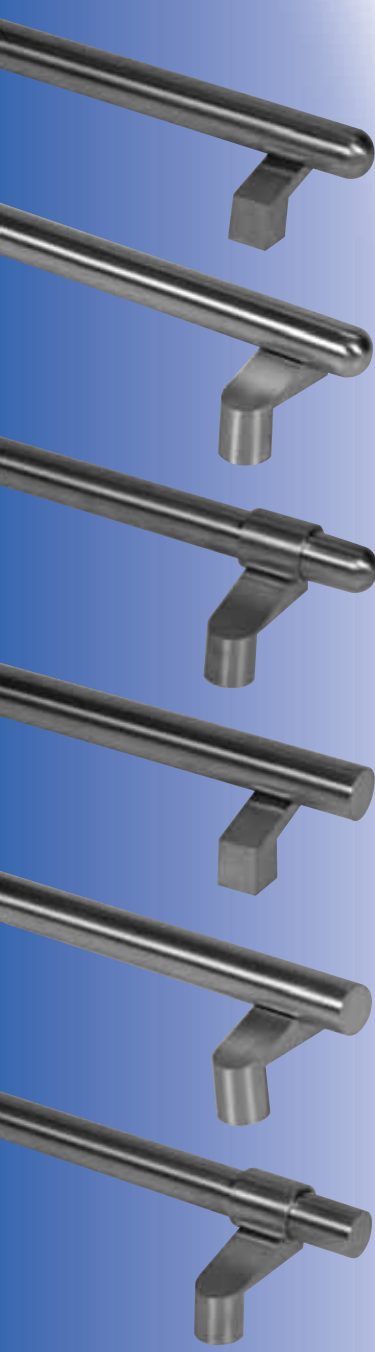

<b>AA4100 Series</b>		
<b>Part #</b>	<b>Material</b>	<b>Length</b>
AA4110	1.00" Dia.	Specify
AA4120	1.25" Dia.	Specify
AA4130	1.50" Dia.	Specify

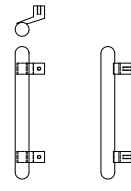

<b>AA4200 Series</b>		
<b>Part #</b>	<b>Material</b>	<b>Length</b>
AA4210	1.00" Dia.	Specify
AA4220	1.25" Dia.	Specify
AA4230	1.50" Dia.	Specify

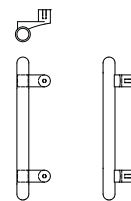

<b>AA4300 Series</b>		
<b>Part #</b>	<b>Material</b>	<b>Length</b>
AA4310	1.00" Dia.	Specify
AA4320	1.25" Dia.	Specify
AA4330	1.50" Dia.	Specify

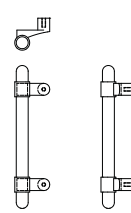

<b>AA4400 Series</b>		
<b>Part #</b>	<b>Material</b>	<b>Length</b>
AA4410	1.00" Dia.	Specify
AA4420	1.25" Dia.	Specify
AA4430	1.50" Dia.	Specify

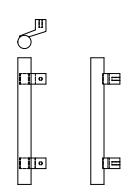

<b>AA4500 Series</b>		
<b>Part #</b>	<b>Material</b>	<b>Length</b>
AA4510	1.00" Dia.	Specify
AA4520	1.25" Dia.	Specify
AA4530	1.50" Dia.	Specify

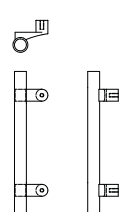

<b>AA4600 Series</b>		
<b>Part #</b>	<b>Material</b>	<b>Length</b>
AA4610	1.00" Dia.	Specify
AA4620	1.25" Dia.	Specify
AA4630	1.50" Dia.	Specify

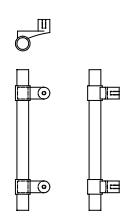

In many cases a cylinder lock or thumb turn may present a problem for a vertically mounted inline pull. There may also be instances where a center mounting post is required on a full length vertical pull mounting on a framed door and drilling a hole in the glass is not an option. With these common conditions in mind Access Architectural Hardware has designed the AA4000 series of offset ladder door pulls. The AA4000 series also aesthetically compliments our AA2000 series of inline ladder pulls. This series is available in a variety of finishes and sizes as well as a split finish. Access Architectural Hardware highly recommends that a center mounting post be added to bars 60" on center or greater.



**Access Architectural Hardware**  
 (319) 208-7822 • Fax (319) 208-7708 • [www.aahardware.us](http://www.aahardware.us)

# AA5000 SERIES

## (RADIUS PULLS)

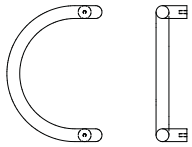

### Part #

AA5110  
AA5120  
AA5130  
AA5140

### AA5100 Series

Material	Length
1.00" Dia.	12"
1.25" Dia.	12"
1.50" Dia.	12"
SPECIFY	SPECIFY

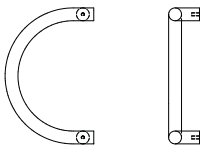

### Part #

AA5210  
AA5220  
AA5230  
AA5240

### AA5200 Series

Material	Length
1.00" Dia.	12"
1.25" Dia.	12"
1.50" Dia.	12"
SPECIFY	SPECIFY

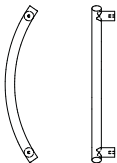

### Part #

AA5310  
AA5320  
AA5330  
AA5340

### AA5300 Series

Material	Length
1.00" Dia.	12"
1.25" Dia.	12"
1.50" Dia.	12"
SPECIFY	SPECIFY



### Part #

AA5410  
AA5420  
AA5430  
AA5440

### AA5400 Series

Material	Length
1.00" Dia.	12"
1.25" Dia.	12"
1.50" Dia.	12"
SPECIFY	SPECIFY

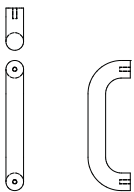

### Part #

AA5510  
AA5520  
AA5530

### AA5500 Series

Material	Length
1.00" Dia.	Specify
1.25" Dia.	Specify
1.50" Dia.	Specify



The Radius AA5000 series of door pulls is another great example of our diversified manufacturing capabilities. Access Architectural Hardware has the capability to produce a wide assortment of radius pulls ranging from semi-circular to arched designs in various diameters, radii, and finishes. This series is available with a split finish. Access Architectural Hardware highly recommends that a center mounting post be added to bars 60" on center or greater.

# AA6000 SERIES

## (RECTANGULAR PULLS)

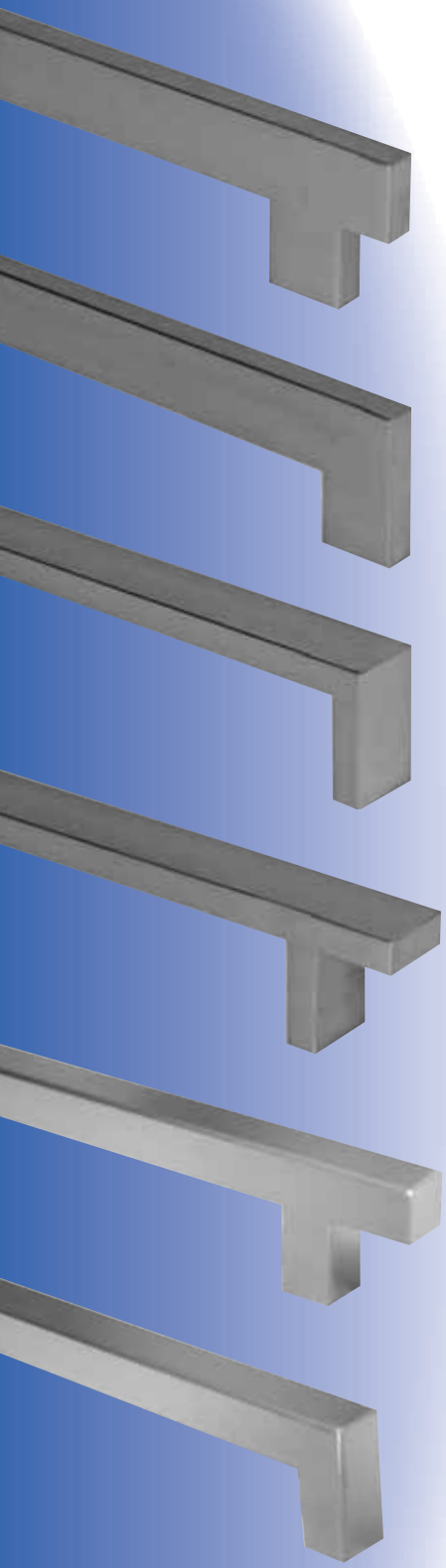

### AA6100 Series

Part #	Material	C. to C.
AA6110	3/4" x 1 3/4"	12"
AA6120	3/4" x 1 1/2"	12"
AA6130	1" x 1 1/2"	12"
AA6140	SPECIFY	SPECIFY

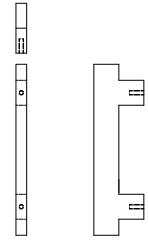

### AA6200 Series

Part #	Material	C. to C.
AA6210	3/4" x 1 3/4"	12"
AA6220	3/4" x 1 1/2"	12"
AA6230	1" x 1 1/2"	12"
AA6240	SPECIFY	SPECIFY

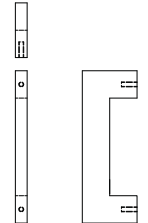

### AA6300 Series

Part #	Material	C. to C.
AA6310	3/4" x 1 3/4"	12"
AA6320	3/4" x 1 1/2"	12"
AA6330	1" x 1 1/2"	12"
AA6340	SPECIFY	SPECIFY

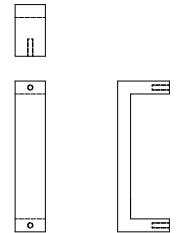

### AA6400 Series

Part #	Material	C. to C.
AA6410	3/4" x 1 3/4"	12"
AA6420	3/4" x 1 1/2"	12"
AA6430	1" x 1 1/2"	12"
AA6440	SPECIFY	SPECIFY

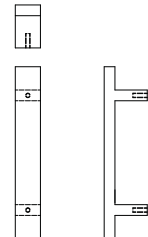

### AA6500 Series

Part #	Material	C. to C.
AA6510	3/4" x 3/4"	12"
AA6520	1" x 1"	12"
AA6530	1 1/4" x 1 1/4"	12"
AA6540	SPECIFY	SPECIFY

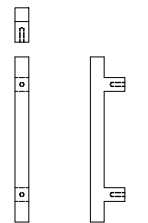

### AA6600 Series

Part #	Material	C. to C.
AA6610	3/4" x 3/4"	12"
AA6620	1" x 1"	12"
AA6630	1 1/4" x 1 1/4"	12"
AA6640	SPECIFY	SPECIFY

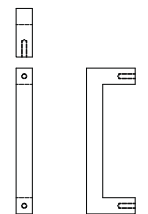

AA6000 series pulls provide a smooth lustrous accent to any entrance. These pulls can be fabricated from both square and rectangular profiles in various sizes, lengths and finishes to meet the architects specification. The popular split finish is also available on all models. Access Architectural Hardware highly recommends that a center mounting post be added to bars 60" on center or greater.



**Access Architectural Hardware**  
 (319) 208-7822 • Fax (319) 208-7708 • [www.aahardware.us](http://www.aahardware.us)



# CUSTOM ARCHITECTURAL HARDWARE DESIGNS

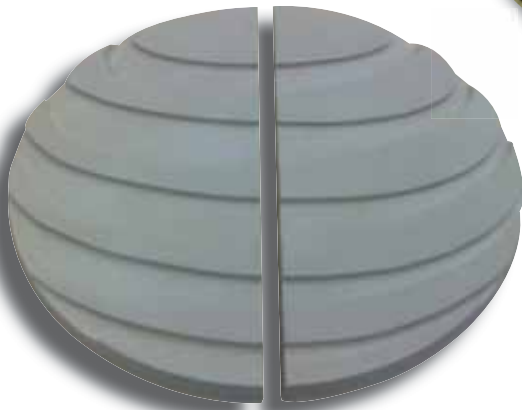

**Access Architectural Hardware**

(319) 208-7822 • Fax (319) 208-7708 • [www.aahardware.us](http://www.aahardware.us)

# MOUNTING DETAILS

## FINISH GLOSSARY

### DESCRIPTIONS

Polished Brass Lacquered  
 Polished Brass No Lacquer  
 Satin Brass Lacquered  
 Satin Brass No Lacquer  
 Antique Brass Lacquered  
 Polished Bronze Lacquered  
 Polished Bronze No Lacquer  
 Satin Bronze Lacquered  
 Satin Bronze No Lacquer  
 Satin Oxidized Bronze  
 Bright Chrome Plate  
 Satin Chrome Plate  
 Satin Clear Anodized Aluminum  
 Polished Stainless Steel  
 Satin Stainless Steel  
 Black Anodized  
 Light Bronze - Anodized  
 Med. Bronze - Anodized  
 Dark Bronze - Anodized  
 Duralon Med. Bronze Powder Coat  
 Duralon Dark Bronze Powder Coat  
 White - Nylon Coat  
 Red - Nylon Coat  
 Black- Nylon Coat

### FINISHES

US3  
 US3N  
 US4  
 US4N  
 US5  
 US9  
 US9N  
 US10  
 US10N  
 US10B  
 US26  
 US26D  
 US28  
 US32  
 US32D  
 DB315  
 2S311  
 2S312  
 2S313  
 R312  
 R313  
 NLW40  
 NLR69  
 NLB80

### BHMA

605  
 606  
 609  
 611  
 612  
 613  
 625  
 626  
 628  
 629  
 630

**Single mounting** *Type 1 MTG*  
 on wood or metal door

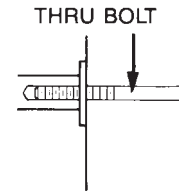

**Fastening details** *Type 2 MTG*  
 for metal and wood doors

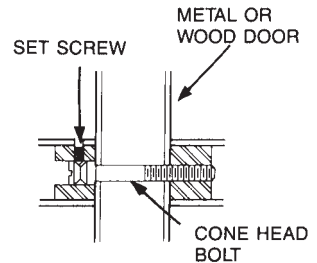

**Fastening details** *Type 4 MTG*  
 for glass mounting

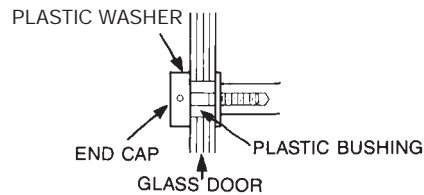

**Back to back mounting** *Type 3 MTG*  
 on glass

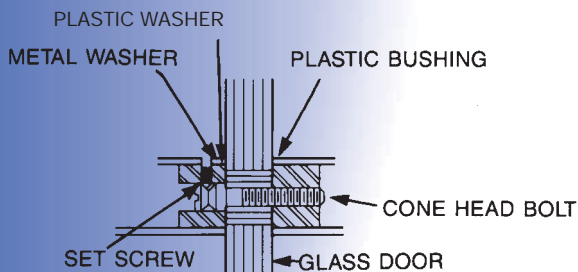

## Standard Mounting Details



Single Thru Bolt



Single Concealed

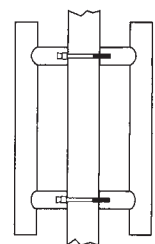

Back to Back

*Type 5 MTG*



**Access Architectural Hardware**

(319) 208-7822 • Fax (319) 208-7708 • www.aahardware.us

# ORDERING INFORMATION

To ensure prompt delivery please furnish the following information:

1. Part number, finish and quantities
2. Single or back to back mounting
  - A) For back to back mounting on glass, please denote the letter "G" at the beginning of the part number.
  - B) For back to back mounting on wood & metal, denote the letter "S" at the beginning of the part number.
  - C) For concealed mounting on wood or metal door, denote the letter "C" at the end of the part number.
  - D) For single mounting on glass, please denote the letter "G" at the end of the part number.
3. Door type
  - A) Glass door specify thickness of glass and diameter of holes in glass
  - B) Metal and wood doors specify thickness of door and type of mounting
4. Brass and bronze finishes please specify lacquer or no lacquer
5. Hand of door
6. Diameter of material required
7. Center line dimensions of push and or pull bar
8. Access Architectural Hardware highly recommends that a center mounting post be added to bars 60" on center or greater.

FOR MORE INFORMATION CALL **(319) 208-7822**

**Access Architectural Hardware**

**P.O. Box 517**

**Keokuk, Iowa 52632**

**www.aahardware.us**

**Email: info@aahardware.us**

**Fax: (319) 208-7708**

## FINISHES:

Access Architectural takes pride in the ability to be able to produce most of our products in a wide variety of architectural finishes. A finish chart is available for reference on page 10. For proper finish maintenance please contact our office.



## Split Finish

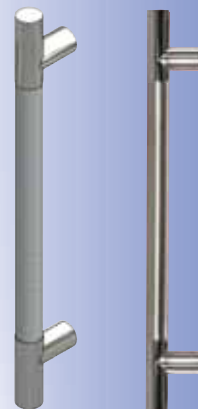

Access Architectural Hardware offers a split finish (brushed and polished) on most architectural push and pull handles. Specify both finishes and the letters "SF" at the beginning of the part number.

# Access Architectural Hardware

(319) 208-7822 • Fax (319) 208-7708 • www.aahardware.us

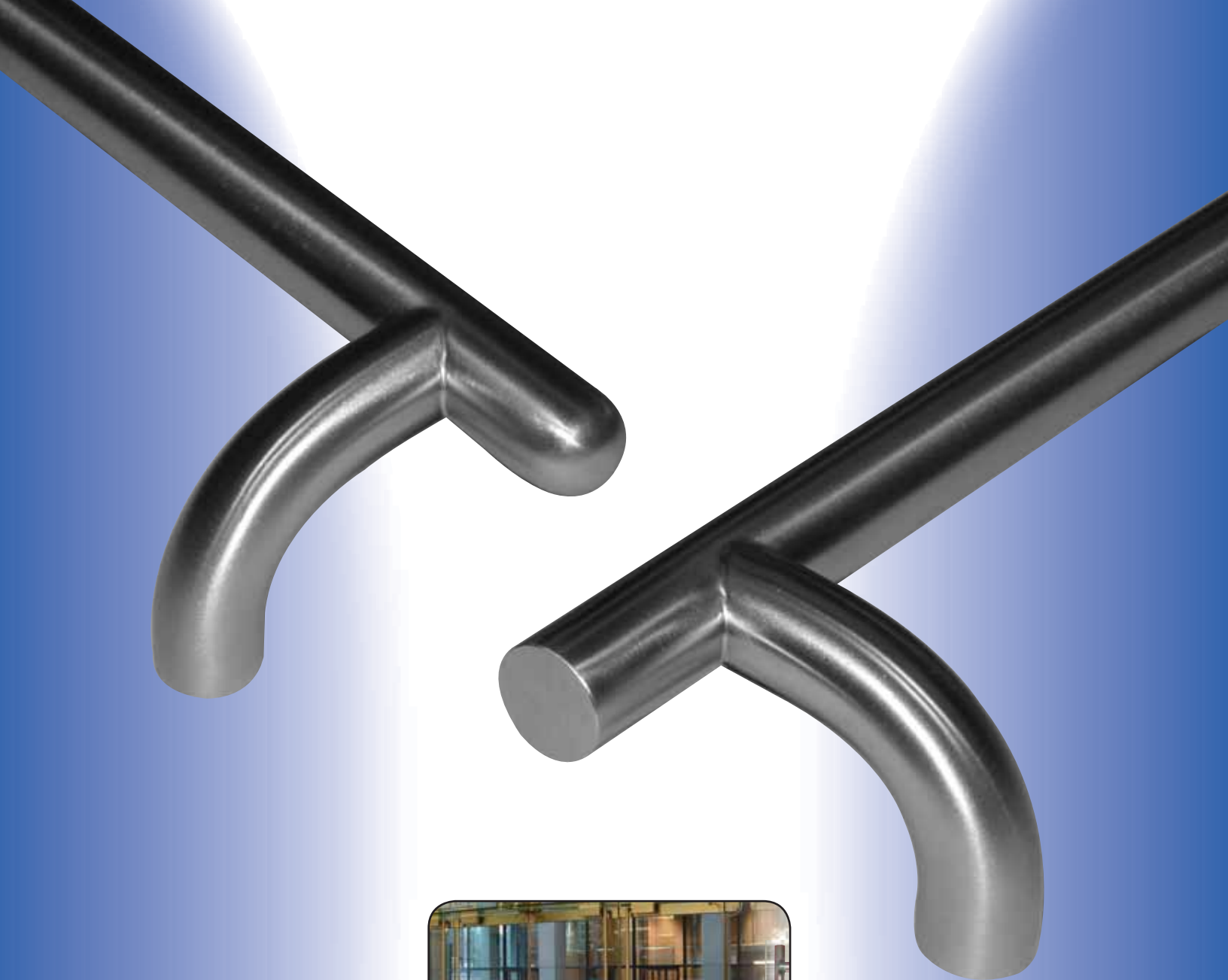

Access Architectural Hardware is a division of Access Door. Access Door is the exclusive manufacturer and distributor of the "Smart Touch" and "Smart Grip" Access Control/Egress Devices. For more information please visit [www.accessdoor.us](http://www.accessdoor.us).



## Access Architectural Hardware

(319) 208-7822 • Fax (319) 208-7708 • [www.aahardware.us](http://www.aahardware.us)